

EASYCHLORGEN

Safe, reliable & efficient on-site generation of sodium hypochlorite



The safe generation of sodium hypochlorite

EASYCHLORGEN sodium hypochlorite systems generate sodium hypochlorite from brine by electrolysis. The sodium hypochlorite has a concentration of c. 0.8 %.

As the sodium hypochlorite solution produced is not aggressive and is very low on minerals, extensive cleaning and de-scaling of the injection nozzles is no longer required.

Conventional sodium hypochlorite losses up to 20 % of the chlorine it contains during storage. The 1 % sodium hypochlorite generated by EASYCHLORGEN does not require any additives; its chlorine contents remains stable over months.

Generated in close proximity to the process, the direct storage and dosing of sodium hypochlorite rules out accidental spillage of the sodium hypochlorite and contact with the operating personnel.

Easy handling

The operator need only fill the salt dissolving container with salt. EASYCHLORGEN generates a diluted brine solution in the correct solution from the saturated brine thus produced which is optimally matched to electrolysis. The diluted brine is guided to the electrolytic cell in which sodium hypochlorite is generated using electric current. This procedure is repeated until the supply tank has been filled.

Lutz-Jesco GmbH provides a wide range of dosing pumps and accessories as well as complete dosing solutions to transport the sodium hypochlorite safely to the process.

Functions

- Production of < 1% sodium hypochlorite via the local electrolysis of brine
- Safe and completely sealed electrolysis procedure
- Easy to operate
- Integrated control with OLED screen and simple 3-button operation
- Manual and automatic operation
- Multilingual operating display option
- Telemetry alarm event & data logging option
- Performance classes from 25 g/h – 8.5 kg/h sodium available

Advantages

- Eliminate delivery & handling of hazardous chemicals
- Handle only salt
- Generate on site for on-demand or residual storage
- No exhaust gases as with conventional sodium hypochlorite solutions in dosing pumps
- Eliminate injection point scaling associated with commercial sodium and calcium hypochlorites
- Considerable Health & Safety benefit to operators

Areas of Application

- Chlorination of potable water supplies
- Food washing / processing treatment
- Dairies / Breweries cleaning in place (CIP)
- Cooling tower biocide treatment
- Secondary disinfection
- Industrial chlorination treatments
- Swimming & Spa pool disinfection

Product Description EASYCHLORGEN Compact 25, 50, 100 g/h chlorine production

EASYCHLORGEN Compact Modular (Wall mounted)

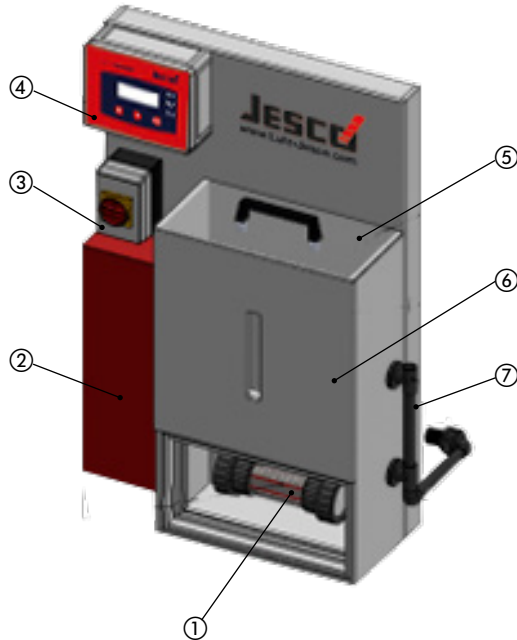

No.	Description
①	Electrolytic cell
②	Water inflow module
③	Main switch
④	Control box
⑤	Salt dissolving container
⑥	Visual salt level indicator and brine saturation chamber
⑦	Ventilation exhaust
⑧	Product tank
⑨	Floor standing skid and integrated spill containment

EASYCHLORGEN COMPACT Skid-1

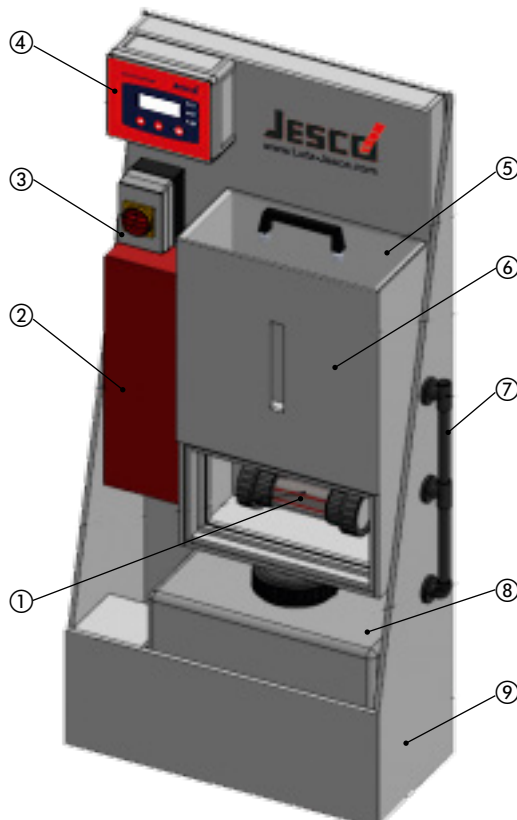

EASYCHLORGEN COMPACT Skid-2

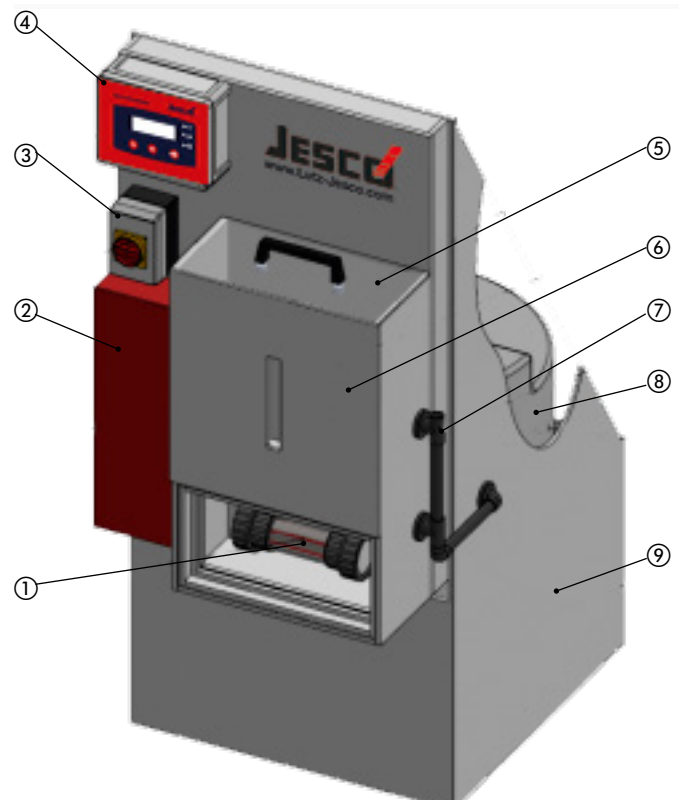

Product Description EASYCHLORGEN Standard 180, 280, 560, 1100, 2200 g/h chlorine production

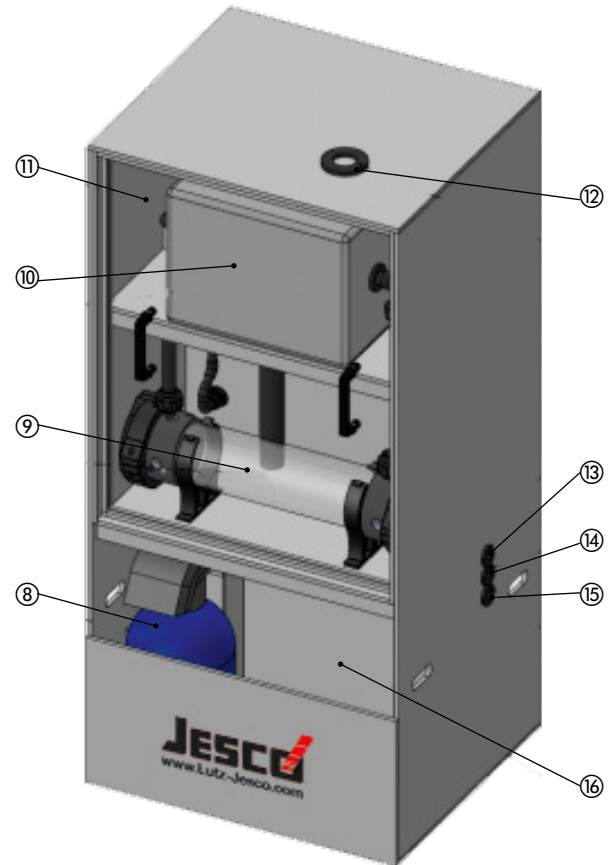
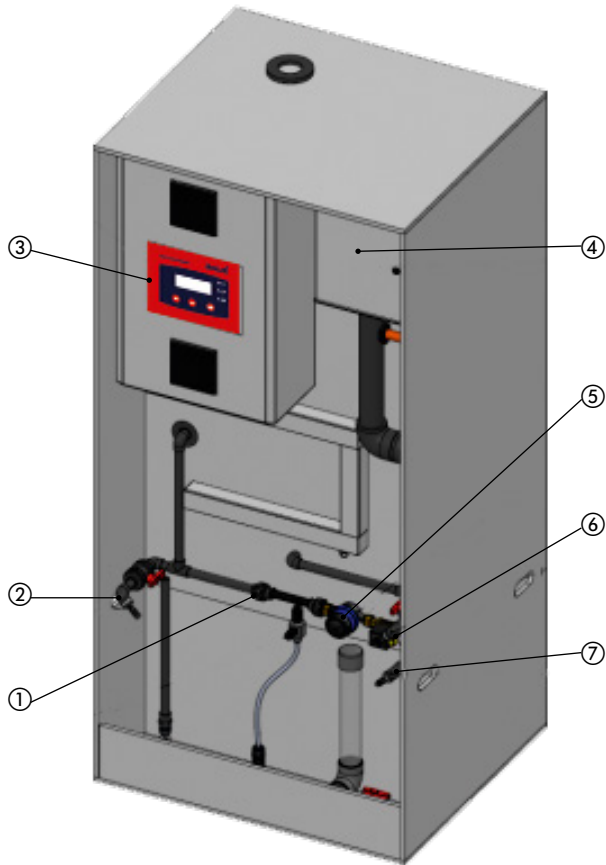

No.	Description
①	Injector for brine
②	Sampler tap for diluted brine
③	Control box
④	Fan
⑤	Flow meter for the dilution water
⑥	Sampler tap for the sodium hypochlorite product
⑦	Sampler tap for DI water
⑧	Water softener
⑨	Electrolytic cell
⑩	Integrated product and de-gassing tank
⑪	Sealed electrolysis chamber
⑫	Ventilation exhaust connection
⑬	Product outlet connection
⑭	Connection for DI water
⑮	Water connection
⑯	Integrated salt dissolving container

Product Description EASYCHLORGEN High Capacity 4.25, 8.5 kg/h chlorine production

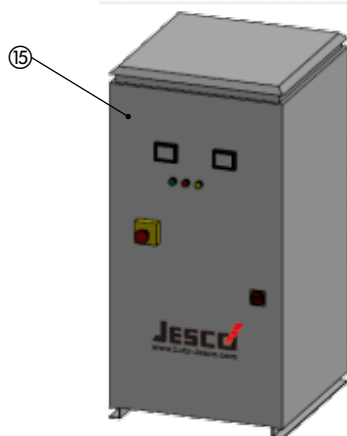
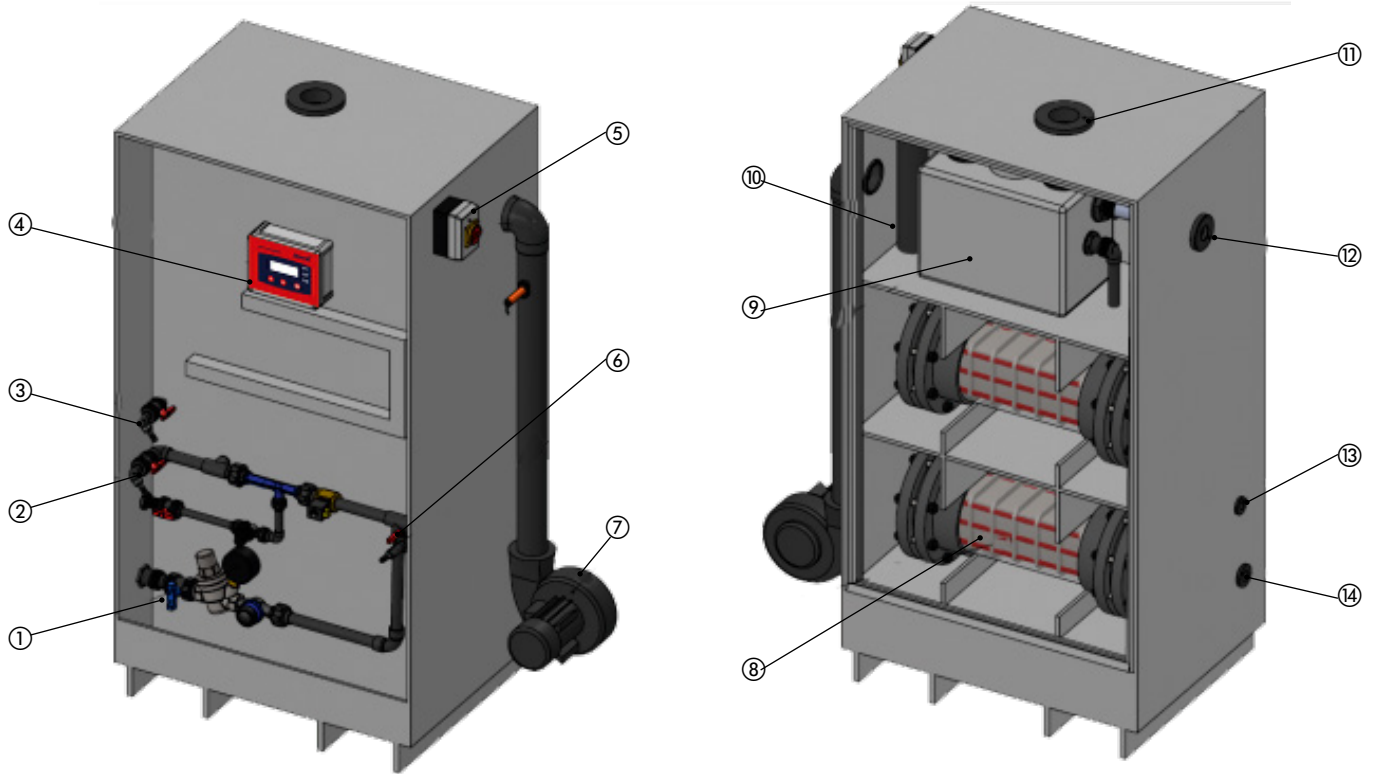

No.	Description
①	Pressure-relief valve and water inflow fittings
②	Sampler tap for diluted brine
③	Sampler tap for the sodium hypochlorite product
④	Control box
⑤	Main switch
⑥	Sampler tap for DI water
⑦	Centrifugal fan
⑧	Electrolytic cell
⑨	Product and de-gassing tank
⑩	Sealed electrolysis chamber
⑪	Ventilation exhaust connection
⑫	Product outlet connection
⑬	Connection for saturated brine, external salt dissolving container
⑭	Water connection
⑮	Power supply for electrolytic cell (rectifier)

Technical data

Description		EASYCHLORGEN sodium hypochlorite system									
		25	50	100	180	280	560	1100	2200	4250	8500
Chlorine performance	g/h	25	50	100	180	280	560	1100	2200	4250	8500
Chlorine concentration	g/l	5 – 7			5 – 8						
Energy consumption	kWh	0.25	0.50	0.75	0.90	1.4	2.8	5.6	11	21.25	42.5
Power supply	ø	1						3			
Operating pressure	bar	1.5 – 10			1.5 – 8.5						
Water consumption	l/h	5	10	20	26	40	80	157	314	607	1214
Salt consumption	kg/h	0,082	0,164	0,334	0.60	0.93	1.85	3.63	07:26	14:02	28.04
Protection class	IP	54			44						
Permissible ambient temperature	°C	+5 to +40*									
Permissible feed water temperature	°C	+8 to +20**									

* in this case, extra venting is required

** in this case, a water cooler is required

Further specifications upon request

The EASYCHLORGEN is a system for the "in situ" production of the biocide active agent "active chlorine produced from sodium chloride via electrolysis". In accordance with the biocide ordinance, as of 01/09/2015, the member states of the European Union may only use precursors for biocidal active agents produced "in situ" and which are used as disinfectants. These precursors must satisfy the quality requirements made of these substances by DIN EN and be sourced from a manufacturer or supplier listed in accordance with article 95 of the biocide ordinance. Please ask your supplier to confirm conformity with the biocide ordinance (certificate).

Biocidal active agent:

Active chlorine produced from sodium chloride via electrolysis

EC no. mix;

CAS no. not applicable

Precursors:

Sodium chloride

EC no. 231-598-3;

CAS no. 7647-15-5;

Special salt for electrolytic cells DIN EN 16401 and 14805

Dimensions

EASYCHLORGEN COMPACT Modular

All dimensions in mm

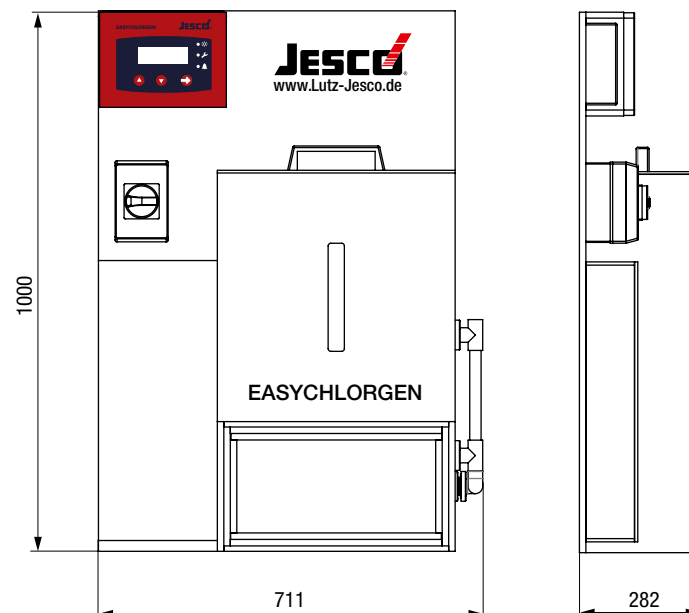

Dimensions

EASYCHLORGEN COMPACT-Skid-1

All dimensions in mm

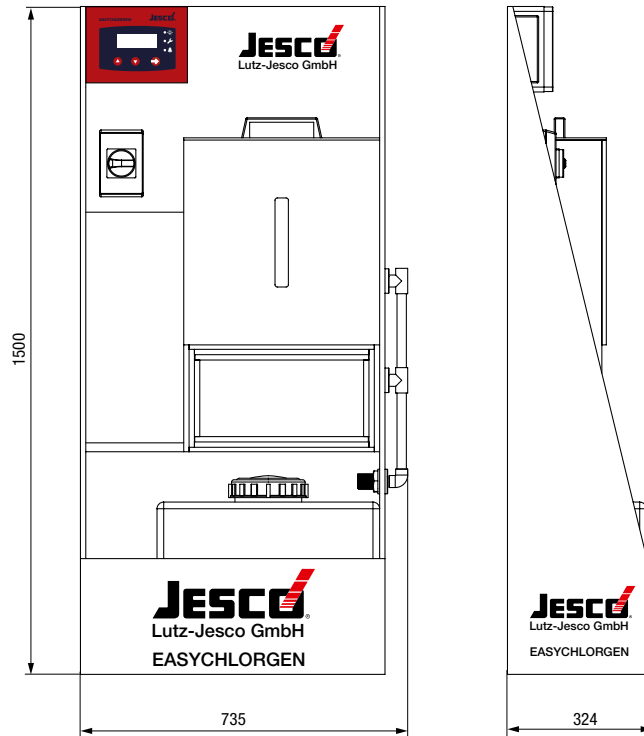

All dimensions in mm

EASYCHLORGEN Compact-Skid-2

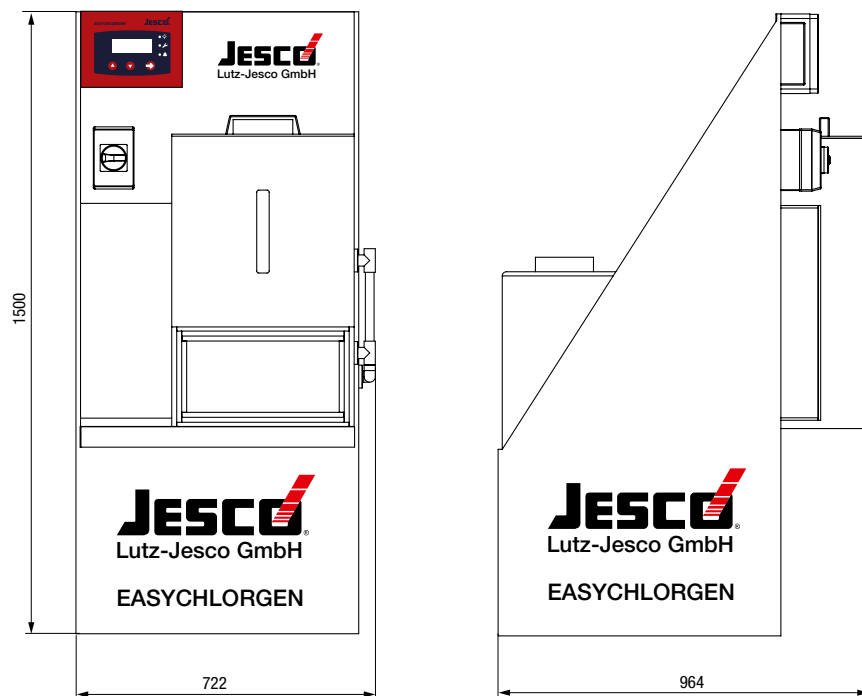

Dimensions

EASYCHLORGEN STANDARD

All dimensions in mm

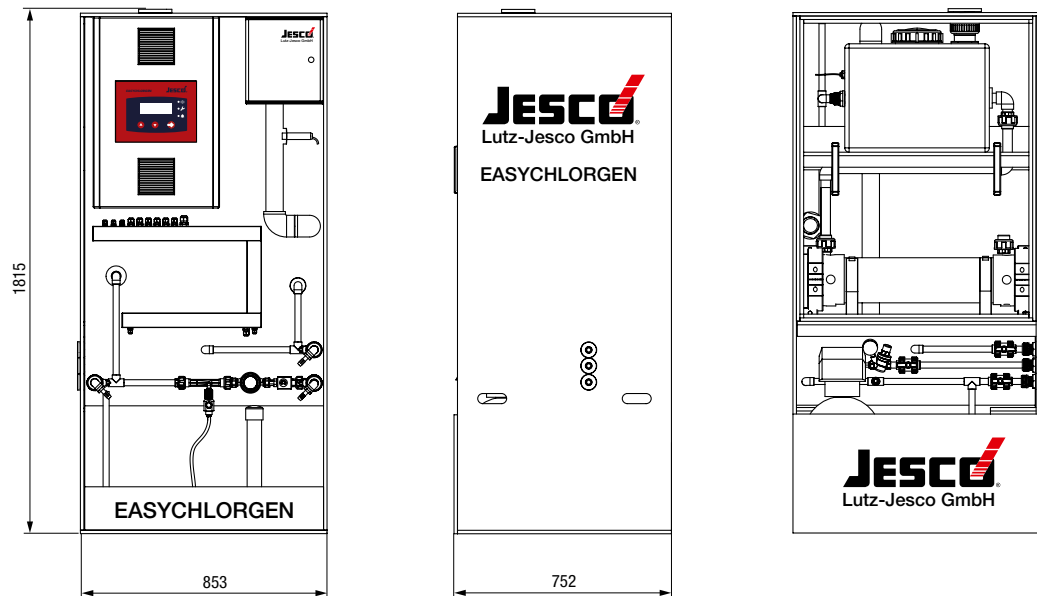

EASYCHLORGEN High Capacity

All dimensions in mm

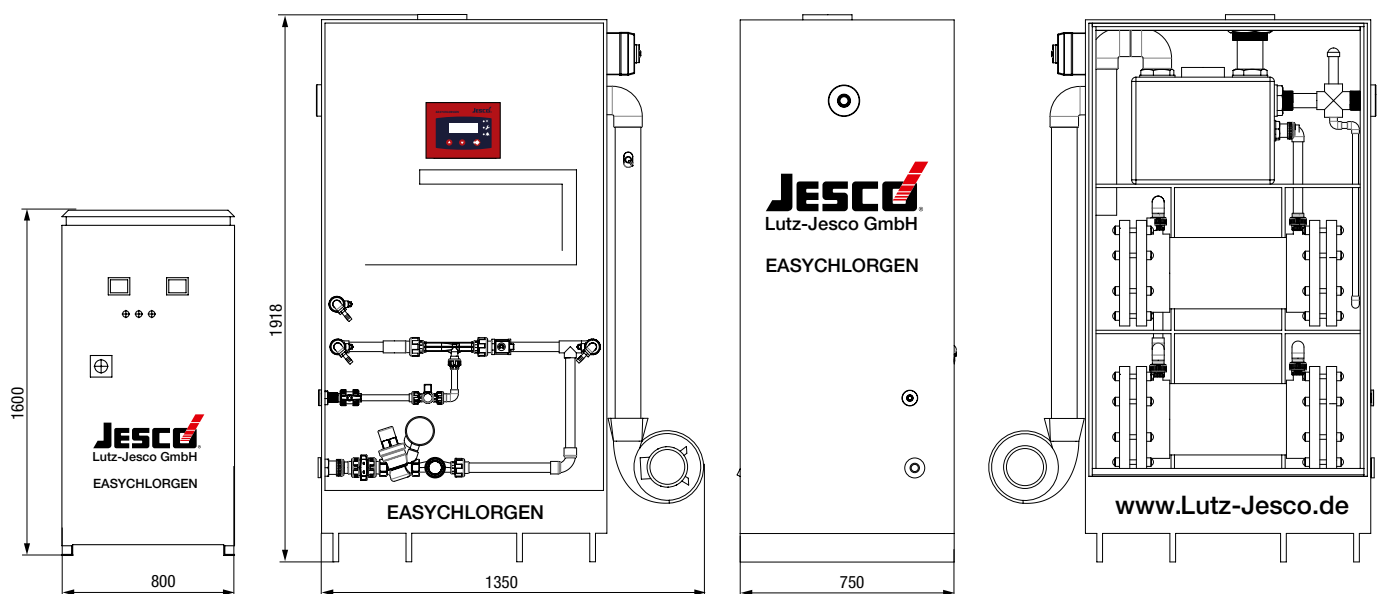

EASYCHLORGEN - Standard version



Components of the compact modular system:

- Sodium hypochlorite system
- Automatic water softening unit
- External 50 litre product storage tank and level control assembly set
- Power supply 240 V AC 50 Hz 1~

EASYCHLORGEN Compact-Modular (Wall mounted)	Type		Generator capacity	Part no.
	C1-M-F1-0-T1-V2	Compact-Modular 25	25 g/hr	65000000
	C2-M-F1-0-T1-V2	Compact-Modular 50	50 g/hr	65000001
	C3-M-F1-0-T1-V2	Compact-Modular 100	100 g/hr	65000002



EASYCHLORGEN

Components of the compact skid system:

- Sodium hypochlorite system
- Automatic water softening unit
- Integrated 50 litre product storage tank and level control assembly set
- Power supply 240 V AC 50 Hz 1~

EASYCHLORGEN Compact-Skid	Type		Generator capacity	Part no.
	C1-S-F1-0-T1-V2	Compact-Skid 25	25 g/hr	65000003
	C2-S-F1-0-T1-V2	Compact-Skid 50	50 g/hr	65000004
	C3-S-F1-0-T1-V2	Compact-Skid 100	100 g/hr	65000005



EASYCHLORGEN

Components of the standard and high-capacity system:

- Sodium hypochlorite system
- Automatic water softening unit
- Power supply (rectifier) 180 - 560 g/h, 195 - 265 V AC 50 Hz 1~
- Power supply (rectifier) 1100 - 8500 g/h, 380-440 V AC 50 Hz 3~

EASYCHLORGEN Standard and High Capacity	Type		Generator capacity	Part no.
	H1-S0-T0-1	Standard 180	180 g/hr	65000006
	H2-S0-T0-1	Standard 280	280 g/hr	65000007
	H3-S0-T0-1	Standard 560	560 g/hr	65000008
	H4-S0-T0-2	Standard 1100	1100 g/hr	65000009
	H5-S0-T0-2	Standard 2200	2200 g/hr	65000010
	H6-S0-T0-2	High Capacity 4250	4250 g/hr	65000011
	H7-S0-T0-2	High Capacity 8500	8500 g/hr	65000012

EASYCHLORGEN - accessories



Hydrogen gas detector

The hydrogen meter deactivates the EASYCHLORGEN following the detection of hydrogen gas and should be installed directly over the system.

Supplied as standard with every EASYCHLORGEN unit.

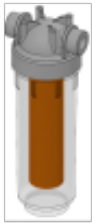

Water Softener

Filter cartridge for use in water softeners for COMPACT systems. Contains an activated carbon cartridge for easy maintenance.

Standard and high capacity softener cartridge options.

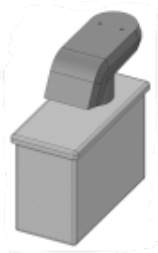

Softener with automatic regeneration

A softening unit with automatic regeneration is available for COMPACT systems.

This requires a power supply and an effluence connection for the flushing water.



Salt dissolving container

External salt dissolving container for STANDARD and HIGH CAPACITY systems.

For 150, 300, 500 and 1000 kg salt.



External product tank

Optional external product tank for STANDARD AND HIGH CAPACITY systems for assembly kit for level monitoring.

Available tank volume: 75, 300, 500, 1000 and 2000 litres.

EASYCHLORGEN - Matchcode



Match code ordering system for EASYCHLORGEN-COMPACT modular systems						
Generator capacity						
C1	Compact 25 - Sodium hypochlorite system for 25 g/h					
C2	Compact 50 - Sodium hypochlorite system for 50 g/h					
C3	Compact 100 - Sodium hypochlorite system for 100g/h					
Modular system configurations						
M	Modular system configurations					
Softener equipment options - cold water supply						
F1	Automatic ion-exchange softener set					
F2	Filter cartridge (capacity 97,000 mg TDS CaCO ₃)					Only available with the
F3	Filter cartridge (capacity 292,000 mg TDS CaCO ₃)					Generator Compact 25
F4	None - softened water available on-site					
Venting package						
1	Air fan and venting set					
0	None optional for Generator Compact 25 - local risk evaluation necessary					
Product storage / rating options						
T1	External 50 litre product storage tank and level control assembly set					
T2	External 100 litre product storage tank and level control assembly set					
T3	External 200 litre product storage tank and level control assembly set					
T4	Special / customer-specific product storage tank and assembly kit for filling level control					
Power supply options						
V1	110 V AC 1~ 50Hz					
V2	240 V AC 1~ 50Hz Standard					
C1	M	F1	1	T1	V2	Example order

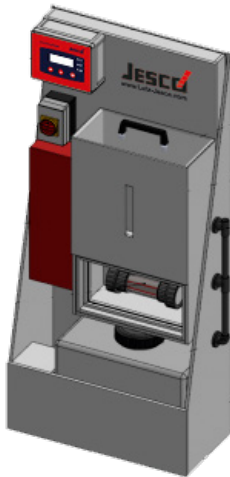

Match code order system for EASYCHLORGEN-COMPACT skid systems			
Generator capacity			
C1	Compact 25 - Sodium hypochlorite system for 25 g/h		
C2	Compact 50 - Sodium hypochlorite system for 50 g/h		
C3	Compact 100 - Sodium hypochlorite system for 100g/h		
System configuration			
S	Frame mounted		
Softener equipment options - cold water supply			
F1	Automatic ion-exchange softener set		
F2	Filter cartridge (capacity 97,000 mg TDS CaCO ₃)		Only available with the Generator Compact 25
F3	Filter cartridge (capacity 292,000 mg TDS CaCO ₃)		
F4	None - softened water available on-site		
Venting package			
0	No air fan		
1	Air fan and venting set		
Product storage / rating options			
T1	Integrated 50 litre product storage tank and assembly kit for fill level control		
T3	Integrated 200 litre product storage tank and assembly kit for fill level control		
Power supply options			
V1	110 V AC 1~ 50Hz		
V2	240 V AC 1~ 50Hz Standard		
C1	S	F1	1
T3	V2		
Example order			

Please note:

All EASYCHLORGEN systems are without dosing pumps and accessories. These articles must be measured and selected for the specific application. Please contact us for further information.

EASYCHLORGEN - Matchcode

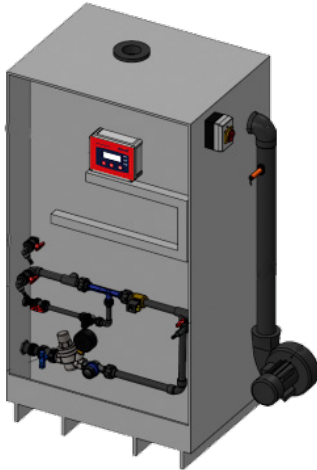

Match code order system for EASYCHLORGEN-STANDARD and HIGH-CAPACITY systems

Generator capacity

H1	EASYCHLORGEN Standard 180 - sodium hypochlorite system for 180 g/h
H2	EASYCHLORGEN Standard 280 - sodium hypochlorite system for 280 g/h
H3	EASYCHLORGEN Standard 560 - sodium hypochlorite system for 560 g/h
H4	EASYCHLORGEN Standard 1100 - sodium hypochlorite system for 1100 g/h
H5	EASYCHLORGEN Standard 2200 - sodium hypochlorite system for 2200 g/h
H6	EASYCHLORGEN High Capacity 4250 - sodium hypochlorite system for 4250 g/h
H7	EASYCHLORGEN High Capacity 8500 - sodium hypochlorite system for 8500 g/h

Salt dissolving container option

S0	Integrated salt dissolving container for 150 kg
S1	External salt dissolving container for 300 kg
S2	External salt dissolving container for 500 kg
S3	External salt dissolving container for 1000 kg
S4	Salt dissolving container special designs

Product storage / rating options

T0	Integrated 75 L product storage tank
T1	300 litre product storage tank and assembly kit for fill level control
T2	500 litre product storage tank and assembly kit for fill level control
T3	1000 litre product storage tank and assembly kit for fill level control
T4	2000 litre product storage tank and assembly kit for fill level control
T5	Special / customer-specific product storage tank and assembly kit for filling level control

Power supply options

0	95-130 V AC 1~ 50Hz	Only available up to the unit for 560 g/h (c. 25 A)
1	195-265 V AC 1~ 50Hz	available up to the unit for 1100 g/h
2	380-440 V AC 3~ 50Hz	Standard on all units > 1100 g/h
3	Special voltage requirements	

H1 S1 T1 1 Example order

Please note:

All EASYCHLORGEN systems are without dosing pumps and accessories. These articles must be measured and selected for the specific application. Please contact us for further information.

Product range

Lutz Pumpen GmbH
Post Office Box 1462
D-97864 Wertheim
www.lutz-pumpen.com

Product range

Lutz-Jesco GmbH
Post Office Box 100164
D-30891 Wedemark
www.lutz-jesco.com



Barrel and container pumps



Flow meters



Double diaphragm pumps



Centrifugal pumps



Dosing pumps



Chlorinators



Chemical centrifugal pumps



TECHNOPOOL

Products for the disinfection of swimming pool water based on salt water electrolysis and domestic water technology



Measuring and control equipment



Disinfection



System and process technology



The Lutz-Jesco App for iPads and iPhone is available from the iTunes App Store.
Further information on this can be found at www.lutz-jesco.com



Head Office
Lutz-Jesco GmbH
Am Bostelberge 19
30900 Wedemark
Germany

Tel.: +49 5130 5802-0
Fax: +49 5130 580268

E-mail: info@lutz-jesco.com
Internet: www.lutz-jesco.com

Hungary
Lutz-Jesco Üzetág
Vasvári P. u. 9.
9024 Győr
Hungary

Tel.: +36 96 523046
Fax: +36 96 523047

E-mail: info@lutz-jesco.hu
Website: www.lutz-jesco.hu

Austria
Lutz-Jesco GmbH
Aredstraße 7/2
2544 Leobersdorf
Austria

Tel.: +43 2256 62180
Fax: +43 2256 6218062

E-mail: info@lutz-jesco.at
Website: www.lutz-jesco.at

Netherlands
Lutz-Jesco Nederland B.V.
Nijverheidstraat 14 C
2984 AH Ridderkerk
Netherlands

Tel.: +31 180 499460
Fax: +31 180 497516

E-mail: info@lutz-jesco.nl
Website: www.lutz-jesco.nl



Great Britain
Lutz-Jesco (GB) Ltd.
Gateway Estate
West Midlands Freeport
Birmingham B26 3QD
Great Britain

Tel.: +44 121 782 2662
Fax: +44 121 782 2680

E-mail: info@lutz-jesco.co.uk
Website: www.lutz-jesco.co.uk

USA
Lutz-JESCO America Corp.
55 Bernar Park
Rochester, N.Y. 14624
USA

Tel.: +1 585 426-0990
Fax: +1 585 426-4025

E-mail: mail@jescoamerica.com
Website: www.lutzjescoamerica.com

East Asia
Lutz-Jesco East Asia Sdn Bhd
6 Jalan Saudagar U1/16
Hicom Glenmarie Industrial Park
40150 Shah Alam/ Selangor
Malaysia

Tel.: +603 55692322
Fax: +603 55691322

E-mail: info@lutz-jescoasia.com
Website: www.lutz-jescoasia.com

Middle East
Lutz-Jesco Middle East FZE
P.O. Box 9614
SAIF-Free Zone Center
Sharjah
UAE

Tel.: +971 6 5572205
Fax: +971 6 5572230

E-mail: info@jescome.com
Website: www.jescome.com

